

60050 S-Beam, Stainless Steel, IP67

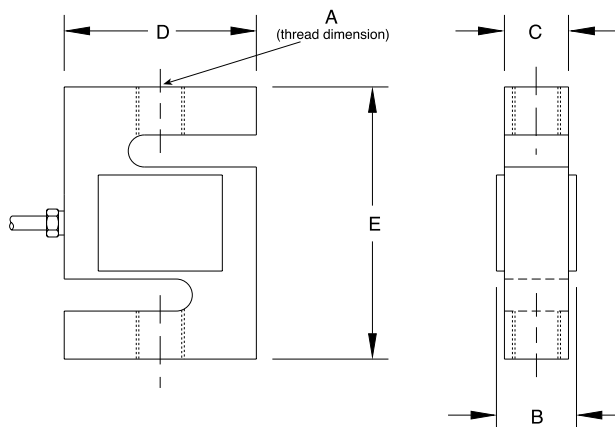

Picture is a representation of actual product



RATED CAPACITY

lb/inches
250
500-1500
2000-3000
5000
10,000
15,000
20,000

A

3/8-24 UNF-2B
1/2-20 UNF-2B
1/2-20 UNF-2B
3/4-16 UNF-2B
3/4-16 UNF-2B
1-14 UNS-2B
1 1/4-12 UNF-2B

B

.75
1.00
1.25
1.25
1.25
1.50
2.00

DIMENSIONS

C

.50
.75
1.00
1.00
1.00
1.25
1.94

D

2.00
2.00
2.00
3.00
3.50
4.00
5.00

E

3.00
3.00
3.00
4.25
4.75
5.50
7.00

kg/mm

113.4
226.8-680.4
907.2-1360.8
2268.0
4535.9
6803.9
9071.9

3/8-24 UNF-2B
1/2-20 UNF-2B
1/2-20 UNF-2B
3/4-16 UNF-2B
3/4-16 UNF-2B
1-14 UNS-2B
1 1/4-12 UNF-2B

19.1
25.4
31.8
31.8
31.8
38.1
50.8

12.7
19.1
25.4
25.4
25.4
31.8
49.3

50.8
50.8
50.8
76.2
88.9
101.6
127.0

76.2
76.2
76.2
108.0
120.7
139.7
177.8

SPECIFICATIONS:

Full Scale Output: 3.0 mV/V
Bridge Resistance: 350 ohms, nominal
Material/Finish: Stainless steel
Temperature: Compensated range
0°F to 150°F/-18°C to 65°C
Manufacturer: Vishay Sensortronics
Model Number: 60050
Safe Overload: 150% Full scale
Rated Excitation: 10V DC (15V maximum)
Nonlinearity: 0.03% Full scale

Hysteresis: 0.02% Full scale
Insulation Resistance: 5000 megohms
Seal Type: Environmentally sealed, IP67
Cable Length: 20'/6.1 m
Cable Color Code: Red + Excitation
Black - Excitation
Green + Signal
White - Signal
Warranty: 1-year limited warranty