

BLC

Diamond Series



Beam Load Cell

Stainless Steel, Water resistant Beam Load Cells from Totalcomp

- ✓ **Stainless Steel Construction**
- ✓ **Available with Threaded and Counterbored Load Hole**
- ✓ **Low Profile**



Totalcomp[®] Scales & Components

99 Reagent Lane • Fair Lawn, New Jersey 07410

Fax: 201-797-2287 • Toll Free Fax: 888-797-2288 • Phone: 201-797-2718 • Toll Free Phone: 800-631-0347

Email: sales@totalcomp.com • Website: www.totalcomp.com

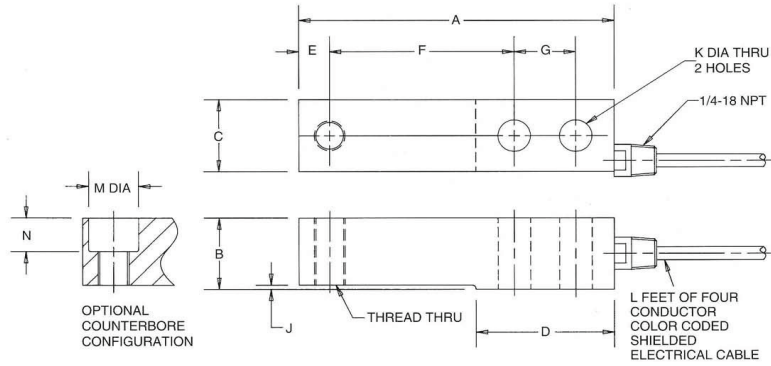

CABLE COLOR CODE

+ EXC	GREEN
- EXC	BLACK
+ SIG	WHITE
- SIG	RED
SHIELD	YELLOW

BLC Diamond Series Load Cells

Matched outputs. Nameplate on cell shows 1.5 mv/v at half capacity. 3 mv/v, 0.02% nonlinearity, 1000/1000 ohm, 17-4 stainless steel. 10 ft 4 cond cable - 500 lb, 1K, 2.5K, 4K ; 20 ft 4 cond cable - 5K, 10K.

Part Number	Capacity	Weight	A	B	C	D	E	F	G	J	K	L	M	N	THREAD SIZE
Threaded load hole															
BLC-250-10716	250 lb	2 lb	5.25	1.19	1.21	2.27	.605	3.00	1.00	.07	.52	10	.81		1/2-20 UNF-2B
BLC-500-10125	500 lb	2 lb	5.25	1.19	1.21	2.27	.605	3.00	1.00	.07	.52	10	.81		1/2-20 UNF-2B
BLC-500-10531 (1K)	1,000 lb	3 lb	5.25	1.19	1.21	2.27	.605	3.00	1.00	.07	.52	10	.81		1/2-20 UNF-2B
BLC-1.25K-10531 (2.5K)	2,500 lb	3 lb	5.25	1.19	1.21	2.27	.605	3.00	1.00	.07	.52	10	.81		1/2-20 UNF-2B
BLC-2K-10531 (4K)	4,000 lb	3 lb	5.25	1.19	1.21	2.27	.605	3.00	1.00	.07	.52	10	.81		1/2-20 UNF-2B
BLC-2.5K-20531 (5K)	5,000 lb	4 lb	6.75	1.44	1.45	3.00	.75	3.75	1.50	.10	.78	20	1.19		3/4-16 UNF-2B
BLC-5K-20531 (10K)	10,000 lb	5 lb	6.75	1.94	1.69	3.00	.75	3.75	1.50	.35	.78	20	1.19		3/4-16 UNF-2B
Counterbored & threaded load hole															
BLC-500-10225	500 lb	2 lb	5.25	1.19	1.21	2.27	.605	3.00	1.00	.07	.52	10	.81	.56	1/2-20 UNF-2B
BLC-500-10631 (1K)	1,000 lb	3 lb	5.25	1.19	1.21	2.27	.605	3.00	1.00	.07	.52	10	.81	.56	1/2-20 UNF-2B
BLC-1.25K-10631 (2.5K)	2,500 lb	3 lb	5.25	1.19	1.21	2.27	.605	3.00	1.00	.07	.52	10	.81	.56	1/2-20 UNF-2B
BLC-2K-10631 (4K)	4,000 lb	3 lb	5.25	1.19	1.21	2.27	.605	3.00	1.00	.07	.52	10	.81	.56	1/2-20 UNF-2B
BLC-2.5K-20631 (5K)	5,000 lb	4 lb	6.75	1.44	1.45	3.00	.75	3.75	1.50	.10	.78	20	1.19	.67	3/4-16 UNF-2B
BLC-5K-20631 (10K)	10,000 lb	5 lb	6.75	1.94	1.69	3.00	.75	3.75	1.50	.35	.78	20	1.19	.79	3/4-16 UNF-2B

Performance

Full Scale Output
3.00 mV/V

Combinded Error
±0.03% FS

Nonlinearity
±0.03% FS

Hysteresis
±0.02%

Creep
±0.03% FS in 20 min.

Non-Repeatability
±0.01% FS

Zero Balance
±1.0% FS

Overload Safe
150% FS

Overload Ultimate
300%

Electrical

Bridge Resistance
Input 1000 ohms
output 1000 ohms

Excitation Voltage
10 VDC (15VDC max)

Insulation Resistance
5000 Mohms

Temperature

Compensated Range
-10C to +40C

Temperature Operating Range
-18C to +65C

Effect on Zero Balance
0.0015% FS/deg F

Effect on FS Output
0.0008% FS/deg F

Mechanical

Material
Stainless Steel

Sealing
IP67

TOTALCOMP LIMITED WARRANTY

Totalcomp warrants this product to be free of defects in materials and/or workmanship and suitable for the purpose(s) intended as outlined on this sheet. This warranty is effective and shall cover the purchaser for one year from the date of shipment from our plant. If this product is found to be defective by our inspection in accordance with the above listed criteria, we will replace or repair it at our expense. For warranty service, please obtain a return authorization number from us and return the item, shipping prepaid, with a written description of the problem. We will respond promptly with the results of our evaluation.



Totalcomp®

Scales & Components

99 Reagent Lane
Fair Lawn, NJ 07410
Fax (201) 797-2287
Toll Free Fax (888) 797-2288
Phone (201) 797-2718
Toll Free Phone (800) 631-0347
Email sales@totalcomp.com
Website www.totalcomp.com