

BEAM LOAD CELL

NWB



Nikkei NWB Single Ended Beam, Stainless Steel.

- ✓ *Welded sealed.*
- ✓ *Interchangeable with Weightronix Weighbar®.*
- ✓ *Reliable-Durable-Precise.*
- ✓ *Available in capacities from 1.25k lbs - 37.5k lbs.*
- ✓ *Includes 20 foot 4 conductor cable.*



Totalcomp® Scales & Components

13-01 Pollitt Drive • Fair Lawn, New Jersey 07410

Fax: 201-797-2287 • Toll Free Fax: 888-797-2288 • Phone: 201-797-2718 • Toll Free Phone: 800-631-0347

Email: sales@totalcomp.com • Website: www.totalcomp.com

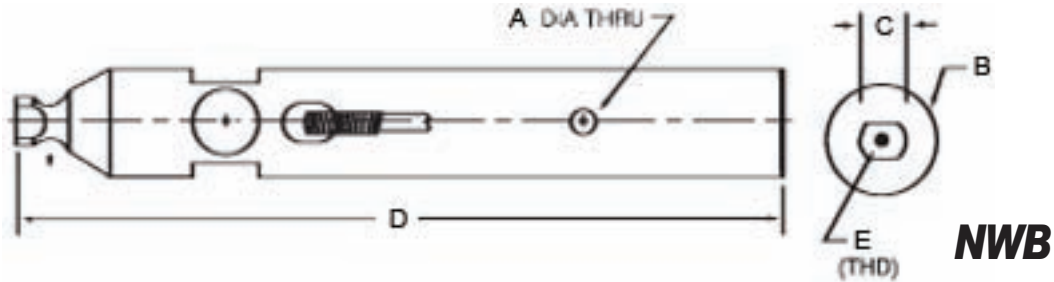

STAINLESS STEEL BEAM LOAD CELL

The *Nikkei* NWB series beam load cells are built to meet or exceed all manufacturers specs for this type of cell. They are constructed from stainless steel and are welded sealed for protection from harsh environments. Interchangeable with the Weightronix Weighbar®.

Part Number	Weigh-Tronix	Capacity	Weight	A	B	C	D	E
NWB-1.25K	14702	1,250 lb	5 lb	0.312	1.25	0.63	11.50	8-32
NWB-2.5K	14703*	2,500 lb	7 lb	0.375	1.25	0.70	11.50	6-32
NWB-5K	13498	5,000 lb	10 lb	0.375	1.62	0.88	10.88	8-32
NWB-10K	13851	10,000 lb	17 lb	0.50	2.50	0.88	12.63	8-32
NWB-25K	18824/17604	25,000 lb	38 lb	0.50	3.50	1.75	15.00	5/16-18
NWB-37.5K (3mv/v)		37,500 lb	38 lb	0.50	3.50	1.75	15.00	5/16-18

Weigh Bar® is a registered trademark of Weigh-Tronix Inc
 *Not interchangeable with 13495-0054-2.5K

Performance

Full Scale Output
2 mV/V

Combined Error
±0.06% FS

Nonlinearity
±0.03% FS

Hysteresis
±0.05%

Creep
±0.05% FS in 1 hour

Non-Repeatability
±0.01% FS

Zero Balance

±1% FS

Overload Safe

150% FS

Overload Ultimate

250% FS

Electrical

Bridge Resistance

Input 350 ohms

Output 350 ohms

Excitation Voltage

10VDC (15VDC Max)

Insulation Resistance

5KMohms@50 VDC

Temperature

Compensated Range

-0°F to +100°F

Temperature Operating Range

-40°F to +180°F

Effect on Zero Balance

0.0013% FS/deg F

Effect on FS Output

0.0008% FS/deg F

Mechanical

Material

Stainless Steel

Finish

Polished SS

Sealing

IP67

Wiring

Cable Length & Type

20 foot, 4 conductor

Cable Color Code

+ Excitation.....Green

- Excitation.....Black

+ Output.....White

- Output.....Red

Shield.....Orange

TOTALCOMP LIMITED WARRANTY

Totalcomp warrants this product to be free of defects in materials and/or workmanship and suitable for the purpose(s) intended as outlined on this sheet. This warranty is effective and shall cover the purchaser for one year from the date of shipment from our plant. If this product is found to be defective by our inspection in accordance with the above listed criteria, we will replace or repair it at our expense. For warranty service, please obtain a return authorization number from us and return the item, shipping prepaid, with a written description of the problem. We will respond promptly with the results of our evaluation.



Totalcomp®

Scales & Components

13-01 Pollitt Drive

Fair Lawn, NJ 07410

Fax (201) 797-2287

Toll Free Fax (888) 797-2288

Phone (201) 797-2718

Toll Free Phone (800) 631-0347

Email sales@totalcomp.com

Website www.totalcomp.com