



- B3G load cells are available in the capacities 50kg ~ 10t and 50lb ~ 20Klb.
- Stainless steel, sealed by adhesive inside, oil-proof, waterproof and anti-corrosion, suitable for all kinds of environments.
- S beam design, tension and/or compression loading possible, easy installation, suitable for crane scale, mechanical conversion scale, hopper scale and other electronic weighing devices.
- Safe and anti-explosive product, can be used in atrocious environment and hazardous areas.

Features

- Capacity: 50kg ~ 10t ; 50lb ~ 20Klb
- High accuracy
- Stainless steel construction
- Low profile
- OIML Certificates No: R60/2000-CNI-06.02
- PTB Approval No: D09-06.07
- NTEP Certificates No: CC06-099

Accessory

- HL-3-001 • HL-3-002
- HL-3-003 • HL-3-004 • HL-3-005

Specifications

Capacity	t	0.05/0.1/0.25/0.5/1/2.5/5/7.5/10						
	lb	50/75/100/150/200/250/300/500/750/1K/1.5K/2K/2.5K/3K/5K/7.5K/10K/15K/20K						
Accuracy		C2	C3	C4	A5S	A5M	B10S	B10M
Approvals		OIML R60 C3			III 5000 Single	III 5000 Multiford	IIIL 10000 Single	IIIL 10000 Multiford
Maximum number of verification intervals	n _{max}	2000	3000	4000	5000	5000	10000	10000
Minimum load cell verification interval	v _{min}	Emax/5000	Emax/10000	Emax/14000	Emax/15000	Emax/15000	Emax/10000	Emax/10000
Combined error	(%FS)	≤±0.030	≤±0.020	≤±0.018	≤±0.018	≤±0.026	≤±0.035	≤±0.050
Creep	(%FS/30min)	≤±0.024	≤±0.016	≤±0.012	≤±0.012	≤±0.017	≤±0.030	≤±0.040
Temperature effect on sensitivity	(%FS/10°C)	≤±0.017	≤±0.011	≤±0.009	≤±0.009	≤±0.013	≤±0.030	≤±0.040
Temperature effect on zero	(%FS/10°C)	≤±0.023	≤±0.015	≤±0.010	≤±0.010	≤±0.014	≤±0.030	≤±0.020
Output sensitivity	(mv/v)	3.0±0.008						
Input resistance	(Ω)	430±60						
Output resistance	(Ω)	351±2.0						
Insulation resistance	(MΩ)	≥5000(50VDC)						
Zero balance	(%FS)	1.0						
Temperature, compensated	(°C)	-10~+40						
Temperature, operating	(°C)	-35~+65						
Excitation, recommended	(V)	5~12(DC)						
Excitation, max	(V)	18(DC)						
Safe overload	(%FS)	150						
Ultimate overload	(%FS)	300						

Outline Dimension mm(inch)

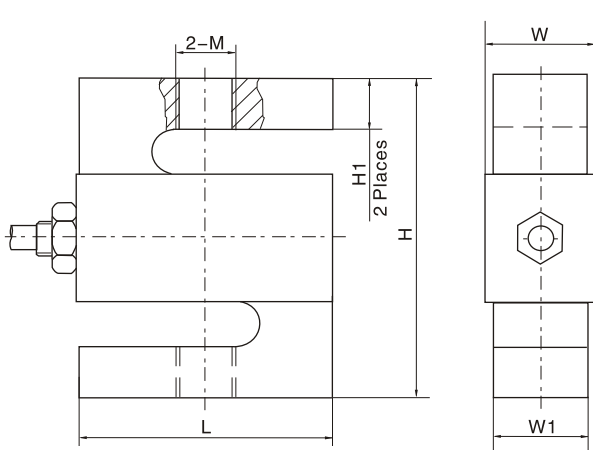

Capacity	Dimension mm	L	H	W1	W	M	H1
50kg, 100kg		50.8	60.96	11.68	15.06	M8	8.89 (0.35)
50lb ~ 300lb		(2.0)	(2.4)	(0.46)	(0.59)	1/4-28UNF	
250kg, 500kg		50.8	60.96	18.03	21.4	M12	
500lb ~ 1.5Klb		(2.0)	(2.4)	(0.71)	(0.84)	1/2-20UNF	
1t		50.8	60.96	24.38	27.76	M12	13.97 (0.55)
2.25Klb		(2.0)	(2.4)	(0.96)	(1.09)	1/2-20UNF	
2.5t		76.2	99.06	24.38	27.76	M20 x 1.5	18.37(0.72) 15.75(0.62)
3Klb		(3.0)	(3.9)	(0.96)	(1.09)	1/2-20UNF	
5t		74.68	99.06	30.74	34.12	M20 x 1.5	27.5 (1.08)
10Klb		(2.94)	(3.9)	(1.21)	(1.34)	3/4-16UNF	
7.5t		87.38	139.7	37.08	40.46	M24 x 2	39.9 (1.57)
15Klb		(3.44)	(5.5)	(1.46)	(1.59)	1-14UNS	
10t		112.78	177.8	42.93	46.31	M30 x 2	13.97 (0.55)
20Klb		(4.44)	(7.0)	(1.69)	(1.82)	1 1/4-12UNS	
5Klb		76.2	99.06	24.38	27.76	3/4-16UNF	
		(3.0)	(3.9)	(0.96)	(1.09)		

Wiring:

Adopt shielded, 4 conductor cable: Φ5mm
Standard cable length: 6m

